

These instructions will guide you through the installation of your dual wheel connectors. The connector should be installed between the two wheels. When installing the connector, be sure to install the wheels with the valve stems facing outward.

Parts Included:
Dual wheel connectors (2)
Part # 01-02-477

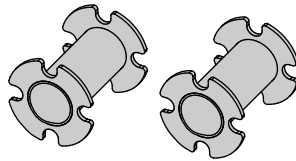

Tools You Will Need:
Two 15/16 inch wrenches, socket wrenches or adjustable wrenches

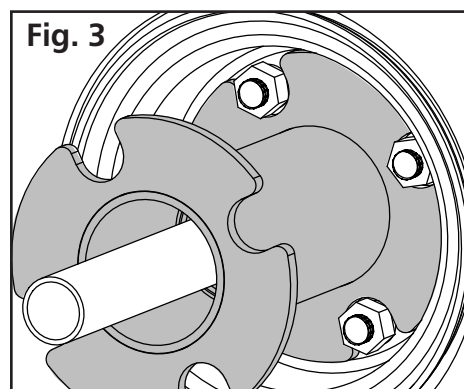
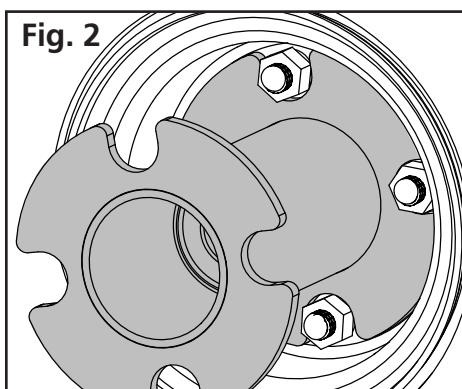
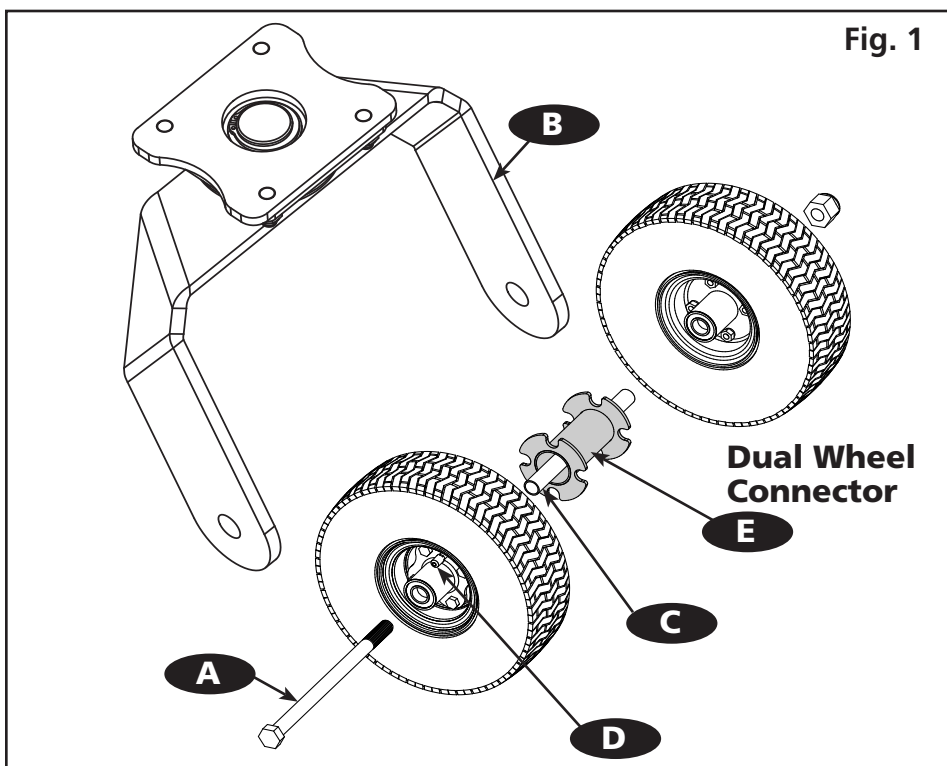

- 1.** Begin by removing the axle bolt (A) from either set of dual wheels.
- 2.** Remove the dual wheel assembly from the wheel forks (B).
- 3.** Separate the wheels and remove the axle shaft (C) from the wheel hub assembly.
- 4.** Position each wheel **with the valve stem(D) facing out.**
- 5.** Place the dual wheel connector(E) over one wheel hub so the connector engages the bolts on the inside of the hub and locks in place. (Fig 2)
- 6.** Insert the axle shaft through the center of the dual wheel connector and into the wheel hub. (Fig 3)
- 7.** Place the second wheel over the axle shaft and wheel connector so the bolts on the inside of the second wheel hub lock in place with the dual wheel connector. When installed properly, the dual wheel connector should prevent the wheels from spinning independently.

Note: Be sure both valve stems face outward.

- 8.** Holding the dual wheel assembly together, position the wheels between the wheel forks.
- 9.** Install the axle bolt and tighten firmly.
- 10.** Repeat steps 1 - 9 for the second set of dual wheels.