

Assembly and Installation

This Mower Deck Adapter (MDA) is designed to work with several mower deck designs. The MDA does not need an airtight fit to deliver exceptional vacuum performance. It simply needs to be installed in front of the opening on the mower deck. Follow the instructions below to install.

Safety Note:

If you remove the Mower Deck Adapter later, you MUST re-install the grass deflector.

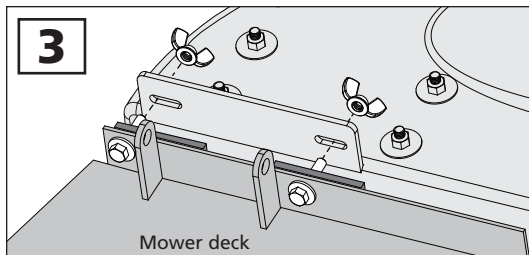
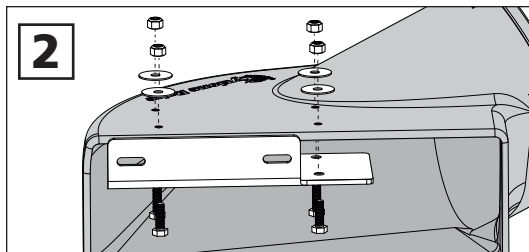
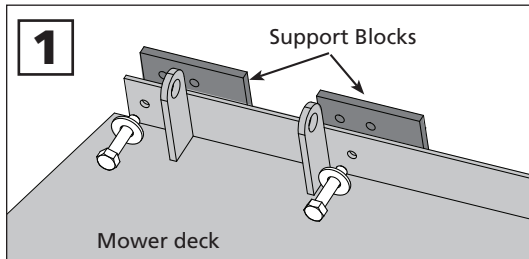

1. Remove the grass deflector from your mower deck to expose the deck opening.
 2. Thread the two 5/16 x 1.5-inch bolts with washers through the holes in the mower deck flange and support blocks (Fig. 1).
 3. Place the 020 Boot Plate INSIDE of the boot and install four 5/16 x 1-inch bolts up through the boot plate and boot. Place one fender washer on top of each bolt and secure with 5/16 nylon lock nuts.
 4. Position the MDA with the 020 boot plate onto the bolts and fasten with the two wing nuts (Fig. 2).
- NOTE:** The support blocks should be between the mower deck flange and the 020-Boot Plate.
5. Snap the hose collar onto the MDA with the latches provided. Cut the hose to length as described in your owner's manual.

That's it you're finished.

COMPONENT LIST

MDA-020

PART NO.	NAME	QTY
01-02-142	Short Boot w/strikes	1
05-02-145	Short Boot w/strikes - XL	1
06-02-145	Short Boot w/strikes - Z-10	1
01-01-150	5/16-18 x 1.5 full tread bolt	2
01-01-151	5/16-18 Nylon lock nut	4
01-01-152	5/16 Washer type A series W	2
01-01-171	5/16-18 x 1 Hex bolt	4
01-01-175	5/16 Fender washer	4
01-01-1914	Wing nut	2
01-01-994	020-Boot Plate	1
01-02-125	Support block, 1.5 bolt & washer	2
01-02-564	Standard strike w/hardware	3
01-02-142	8" x 8" Collar complete - green	1
01-02-486	7" x 8" Collar complete	1
05-02-080	8" x 8" Collar complete - yellow	1
06-02-080	10" x 10" Collar complete	1
08-02-080	8" x 6" Collar complete	1

