

Assembly and Installation

This Mower Deck Adapter (MDA) is designed to work with several mower deck designs. The MDA does not need an airtight fit to deliver exceptional vacuum performance. It simply needs to be installed in front of the opening on the mower deck. Follow the instructions below to install.

Safety Note:
If you remove the Mower Deck Adapter later, you MUST re-install the grass deflector.

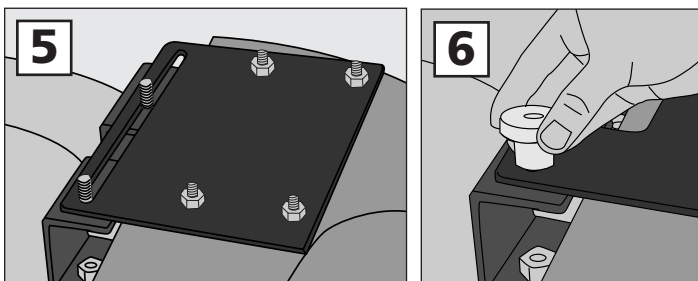
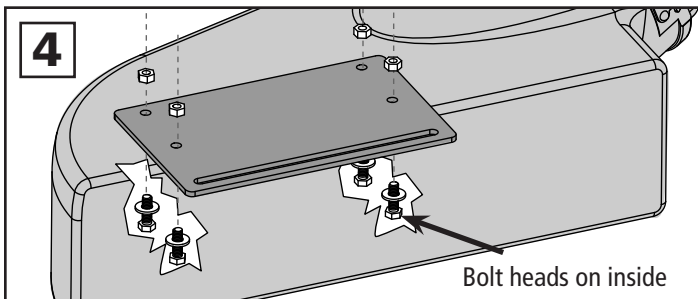
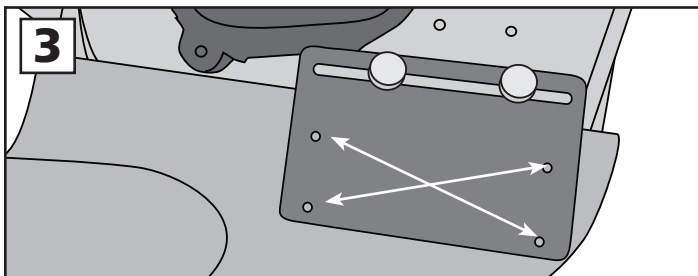
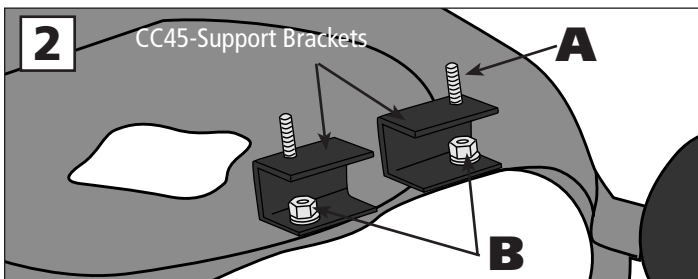
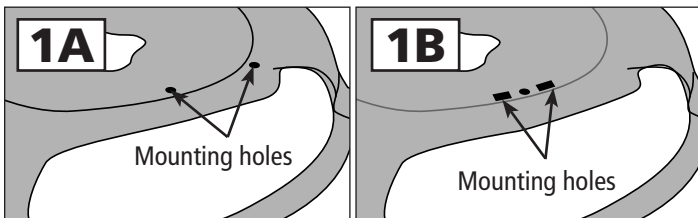

1. Remove the hinged grass deflector from your mower deck to expose the deck opening and deflector mounting holes.
Note: There could be 2 different hole patterns. (1A or 1B)
2. Screw one 5/16-18 x 1-inch bolt (A) up through the top of each CC bracket. Attach the CC45 Support Brackets to your mower deck using the 3/8 x 1 inch bolts, washers and lock nuts (B). The bolts should be installed from the bottom in the holes left by the grass deflector.
3. Put the S-Boot Plate onto the treaded studs and attach with the two Boot Plate Clamp Knobs. Then, position the boot under the boot plate and flush against the deck opening. While holding the boot in place, mark the four bolt hole positions with a marker pen (Fig 3). Loosen the Clamp Knobs and remove the Boot Plate from your mower deck.
4. Place the boot on a stable surface. Using the Boot Plate as a template, drill four 5/16" holes through the boot in the four bolt positions. The best way is to first drill one hole, and then drop a bolt through the hole temporarily to keep the plate lined up. Repeat the process until all holes have been drilled. Install the mounting bolts and tighten. The bolt heads should be on the inside to avoid blocking the boot opening. (Fig 4).
5. Position the MDA in front of your mower deck and lower the slotted opening in the S-Boot Plate over the two 5/16 x 1 inch hex bolts installed on the upper surface of the Support Brackets.
6. Place one rubber washer on each stud. Spin on the Boot Plate Clamp Knobs. Connect the hose collar onto the MDA with the latches and cut the hose to length as described in your owner's manual if needed.

That's it you're finished!

Note: Parts List on reverse.

COMPONENT LIST

MDA-018

PART NO.	NAME	QTY
01-02-145	Short Boot w/strikes	1
05-02-145	Short Boot w/strikes - XL	1
06-02-145	Short Boot w/strikes - Z-10	1
01-01-151	5/16-18 Nylon lock nut	4
01-01-171	5/16-18 x 1 Hex bolt	6
01-01-175	5/16 Fender washer	4
01-01-180	3/8 Washer	4
01-01-240	3/8-16 Nylon lock nut	2
01-01-291	Clamp knob - Boot Plate	2
01-01-408	3/8-16 x 1 Hex bolt	2
01-01-775	S-Boot Plate	1
01-01-1660	CC45-Support Bracket	2
01-01-1990	Rubber washer	2
01-02-564	Standard strike w/hardware	3
01-02-142	8" x 8" Collar complete - green	1
01-02-486	7" x 8" Collar complete	1
05-02-080	8" x 8" Collar complete - yellow	1
06-02-080	10" x 10" Collar complete	1
08-02-080	8" x 6" Collar complete	1

