

## Installation Instructions

The Cyclone Rake 208L Special Hitch is designed to fit multiple mower types. To install the hitch, follow the instructions below.

1. Place the mower on a flat level surface, such as a concrete floor.
2. The 208L Special Hitch attaches to the mower's rear hitch bracket (A), (Fig. 1).
3. Place the 208L Special Hitch Weldment (1) over the mower's hitch bracket with the cleats straddling the hitch, (Fig. 2).
4. Place the 3/4 x 1.75-inch bolt through the installation hole and secure with the nylon lock nut provided.
5. Tighten the hitch bolt.

That's it. Your 208L Special Hitch installation is complete.

**To finish the assembly of your Cyclone Rake, please return to your Owner's Manual now.**

**Note:** Check the hitch bolt before each use to make sure everything is tight.

**User Tip:** A small amount of grease on the Cyclone Rake hitch pins will help minimize hitch bar wear over time.

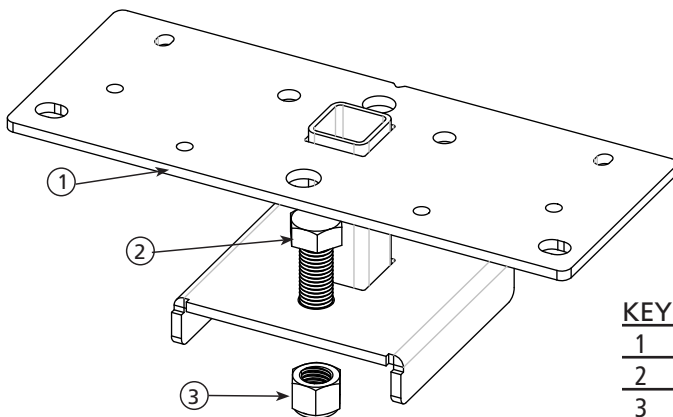
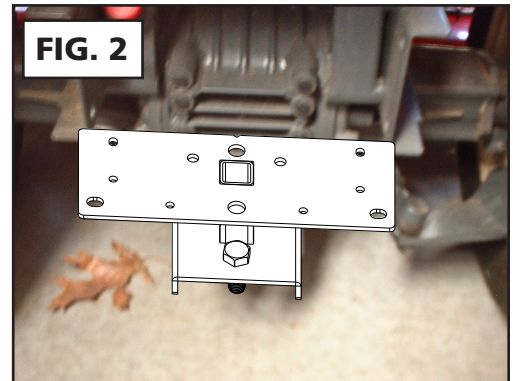
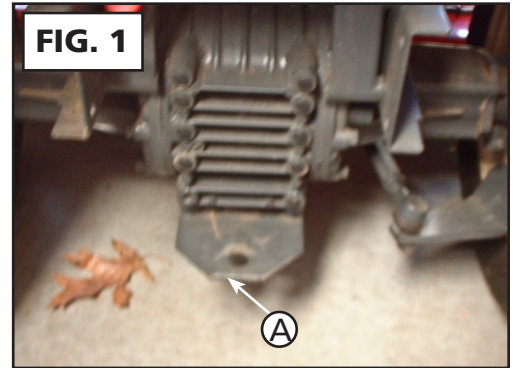

### 208L Special Hitch COMPONENT LIST

KEY #	PART #	NAME	QTY
1	01-02-574	208L Special Hitch Weldment	1
2	01-01-1828	3/4-10 x 1.75 Hex bolt	1
3	01-01-1829	3/4-10 Nylon lock nut	1