

Installation Instructions

The Cyclone Rake 208-010 Special Hitch is designed to fit multiple mower types. To install the hitch, follow the instructions below.

1. Place the mower on a flat level surface such as a concrete floor.
2. Connect the 90° Hitch Bar to the Special Hitch Adapter using two 3/8 x 1.5-inch hex bolts and lock nuts provided. The bolt heads should be on the outside with the lock nuts behind the hitch adapter.
3. Position the 208-010 Special Hitch over the holes in the back of your mower as shown in Fig. 1.
4. Secure the 208-010 Hitch to the mower using the two 5/8 x 2-inch hex bolts as shown in Fig. 2.

Note: Check the bolts before each use to make sure everything is tight.

User Tip: A small amount of grease on the Cyclone Rake hitch pins will help minimize hitch bar wear over time.

That's it. Your 208-010 Special Hitch installation is complete. *To finish the assembly of your Cyclone Rake, please return to your Owner's Manual now.*

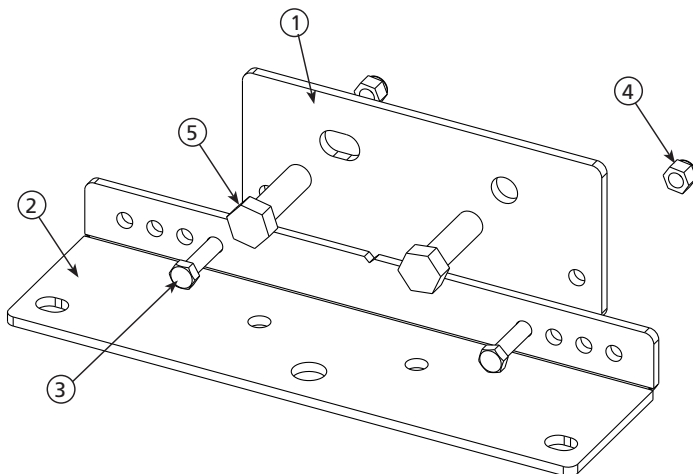
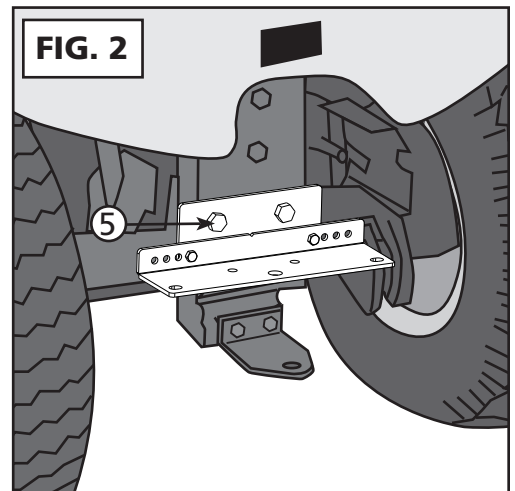
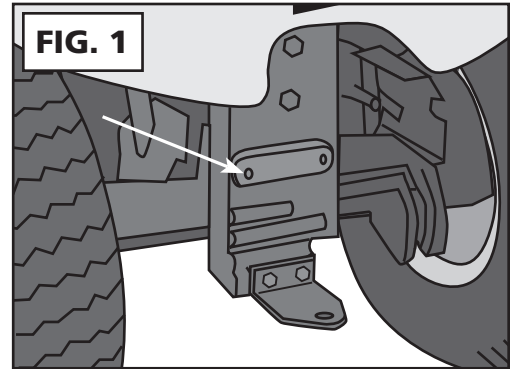

208-010 Special Hitch COMPONENT LIST

KEY #	PART #	NAME	QTY
1	01-01-1813	Special Hitch Adapter	1
2	01-01-870	90° Hitch Bar	1
3	01-01-410	3/8-16 x 1.5 Hex bolt	2
4	01-01-240	3/8-16 Lock nut	2
5	01-01-1041	5/8-11 x 2 Hex bolt	2