

Installation Instructions

The Cyclone Rake 208-002 Special Hitch is designed to fit several mower designs. To install the hitch, follow the instructions below.

1. Place the mower on a flat level surface, such as a concrete floor.
2. The 208-002 Special Hitch attaches to the mower's rear hitch bracket (A), (Fig. 1).
3. Place the 208-002 Special Hitch Weldment (1) over the mower's rear hitch bracket with the cleats straddling the bracket, (Fig. 2).
4. Place the 3/4 x 1.75-inch bolt through the forward installation hole and secure with the nylon lock nut provided.
5. Tighten the hitch bolt.

That's it. Your 208-002 Special Hitch installation is complete.

To finish the assembly of your Cyclone Rake, please return to your Owner's Manual now.

Note: Check the hitch bolt before each use to make sure everything is tight.

User Tip: A small amount of grease on the Cyclone Rake hitch pins will help minimize hitch bar wear over time.

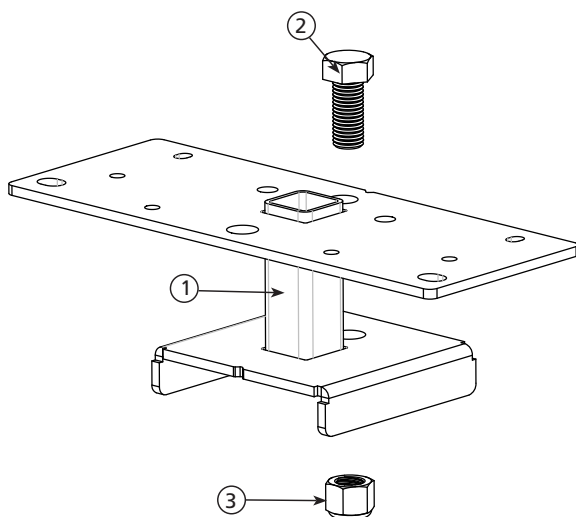
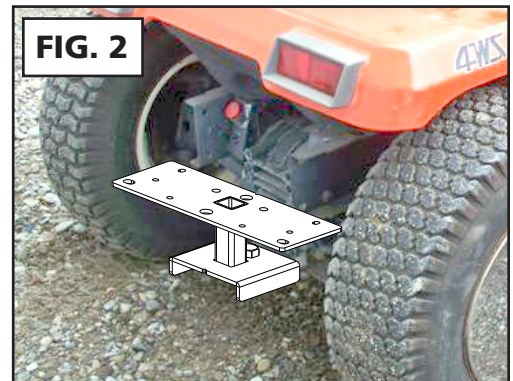

208-002 Special Hitch COMPONENT LIST

KEY #	PART #	NAME	QTY
1	01-02-578	208-002 Special Hitch Weldment	1
2	01-01-1828	3/4-10 x 1.75 Hex bolt	1
3	01-01-1829	3/4-10 Nylon lock nut	1