

## Installation Instructions

The 208-017 Hitch Bar is bolted horizontally to the rear of your mower utilizing your current John Deere rear bumper accessory. The Cyclone Rake uses two hitch pins which drop into holes in the ends of the hitch bar. Once installed, the hitch bar can be left on year-round. To install the hitch bar, follow the instructions below.

1. Place the mower on a flat level surface, such as a concrete floor.
2. Remove the hitch from the rear of the bumper if your tractor looks like (Fig 1). If not, proceed to Step 3.
3. Bolt the 90° hitch bar to the rear bumper using the two 3/8-16 x 1.5" hex bolts and nuts provided. (fig 2)

That's it. Your 208-017 Special Hitch installation is complete.

**To finish the assembly of your Cyclone Rake, please return to your Owner's Manual now.**

**Note:** Check the bolts before each use to make sure everything is tight.

**User Tip:** A small amount of grease on the Cyclone Rake hitch pins will help minimize hitch bar wear over time.

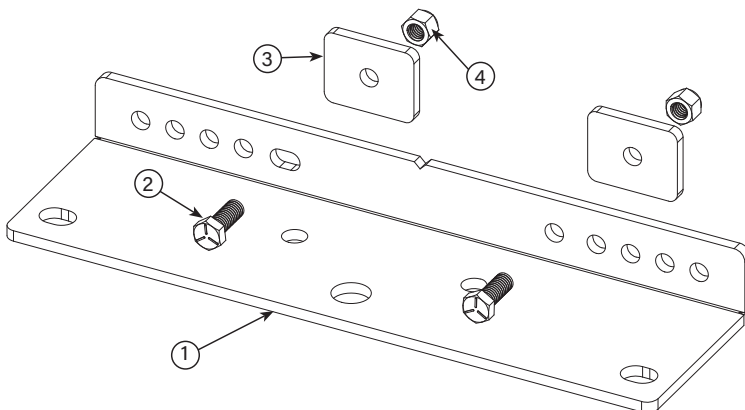
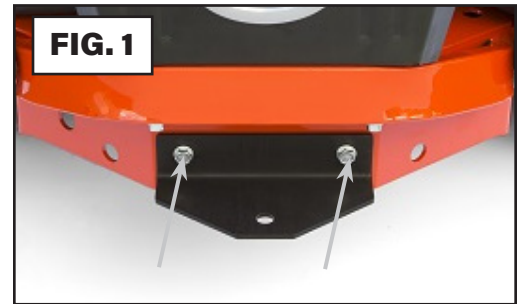

### 208-017 Special Hitch COMPONENT LIST

KEY#	PART #.	NAME	QTY
1	01-01-2092	Special 90° Hitch Bar	1
2	01-01-410	3/8-16 x 1.5 Hex bolt	2
3	01-01-1434	Square washer	2
4	01-01-240	3/8-16 Nylon lock nut	2