

Installation Instructions

The Cyclone Rake 3-Point Special Hitch is designed to fit mowers with either Category 0, Category 1 or John Deere's iMatch hitches. Follow the instructions below to install on Category 1 hitches. For Category 0 and John Deere iMatch(Cat. 1) hitches please use the instructions on the following pages.

3-Point Category 1 Installation

1. Attach the Strut (2) to the Draw Bar (1) as shown in Figure 1. Secure with three M10 bolts (4) and lock nuts (5). Tighten firmly.
2. Connect the pin weldments to the Draw Bar. Connect the pin weldments (3) with the long end facing out as shown in Figure 2. Secure each pin weldment to the Draw Bar using four M10 bolts and lock nuts.
3. Slide the pins on the Special Hitch through the bushings on the arms of your 3-point hitch. Place one set of bridge pins in the inner set of holes in the pin weldment, and the second set outside your hitch bar arms as shown in Figure 3.
4. Connect the Special Hitch Strut to your 3-point hitch. Use the 3/4-inch Category 1 hitch pin (6) and the upper hole in the Strut. Secure with the bridge pin fastener provided (Figure 4).
5. If your mower deck is coupled to your 3-point hitch, please set the mower height to where you would like for mowing, and then set the 3-point hitch so the Draw Bar is 12 inches off the ground. Next, adjust the top arm of your 3-point hitch so that the Strut is in a vertical position (Figure 5).

That's it. Your 3-point Special Hitch installation is complete.

Note: Check the bolts before each use to make sure everything is tight. An extra M10 bolt, M10 lock nut and bridge fastener are included in case you need them.

Tip: A small amount of grease on the Cyclone Rake hitch pins will help minimize Draw Bar wear over time.

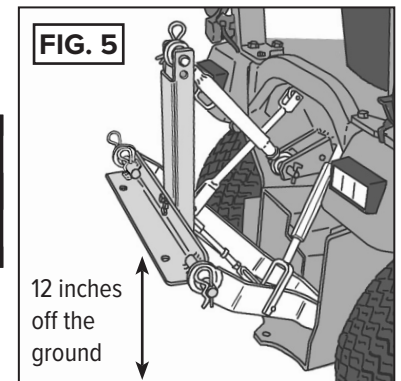
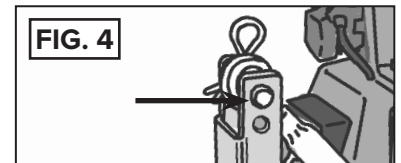
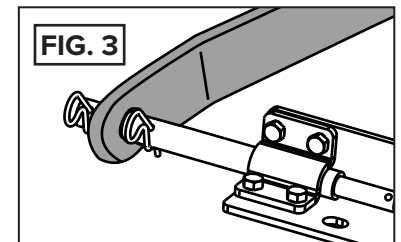
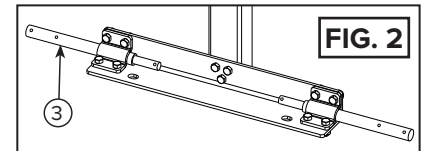
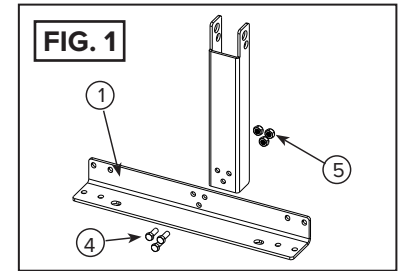

WARNING

Do not attempt to lift your Cyclone Rake off the ground using your 3-point Special Hitch. Damage to the Cyclone Rake and to your hitch will result. This equipment is not designed to be lifted. Damage from lifting is not covered by your warranty.

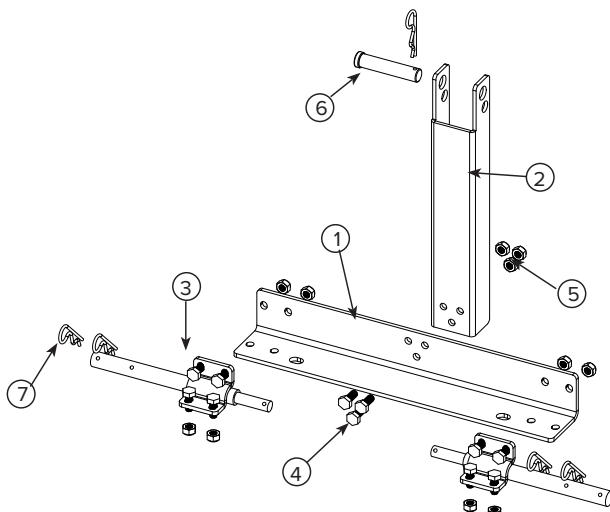

208T Special Hitch COMPONENT LIST

KEY #	PART #	NAME	QTY
1	01-01-1922	208T Draw Bar	1
2	01-01-1923	Strut	1
3	01-02-172	Pin weldment	2
4	01-01-802	M10 x 25mm Hex bolt	12
5	01-01-803	M10 Lock nut	12
6	01-01-849	3/4" Hitch pin - Category 1	1
7	01-01-880	Bridge pin, large	6

3-Point Category 0 Installation

1. Attach the Strut (2) to the Draw Bar (1) as shown in Figure 1. Secure with three M10 bolts (4) and lock nuts (5). Tighten firmly.
2. Connect the pin weldments to the Draw Bar. Connect the pin weldments (3) with the short end facing out as shown in Figure 2. Secure each pin weldment to the Draw Bar using four M10 bolts and lock nuts.
3. Slide the pins on the Special Hitch through the bushings on the arms of your 3-point hitch. Secure with two of the bridge pins provided as shown in Figure 3.
4. Connect the Special Hitch Strut to your 3-point hitch. Use the 5/8-inch Category 0 hitch pin (6) and the lower hole in the Strut. Secure with the bridge pin fastener provided (Figure 4).
5. If your mower deck is coupled to your 3-point hitch, please set the mower height to where you would like for mowing, and then set the 3-point hitch so the Draw Bar is 12 inches off the ground. Next, adjust the top arm of your 3-point hitch so that the Strut is in a vertical position (Figure 5).

That's it. Your 3-point Special Hitch installation is complete.

Note: Check the bolts before each use to make sure everything is tight. An extra M10 bolt, M10 lock nut and bridge fastener are included in case you need them.

Tip: A small amount of grease on the Cyclone Rake hitch pins will help minimize Draw Bar wear over time.

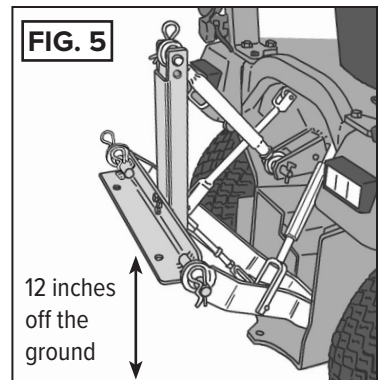
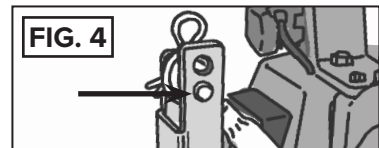
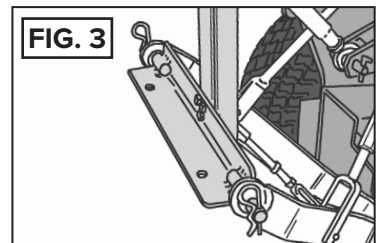
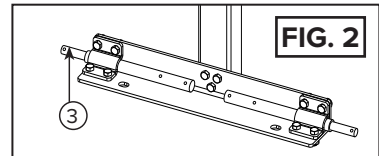
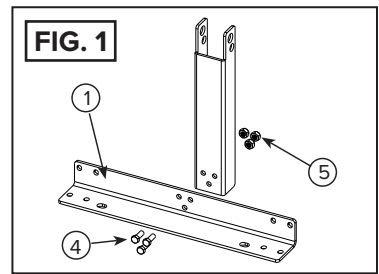

WARNING

Do not attempt to lift your Cyclone Rake off the ground using your 3-point Special Hitch. Damage to the Cyclone Rake and to your hitch will result. This equipment is not designed to be lifted. Damage from lifting is not covered by your warranty.

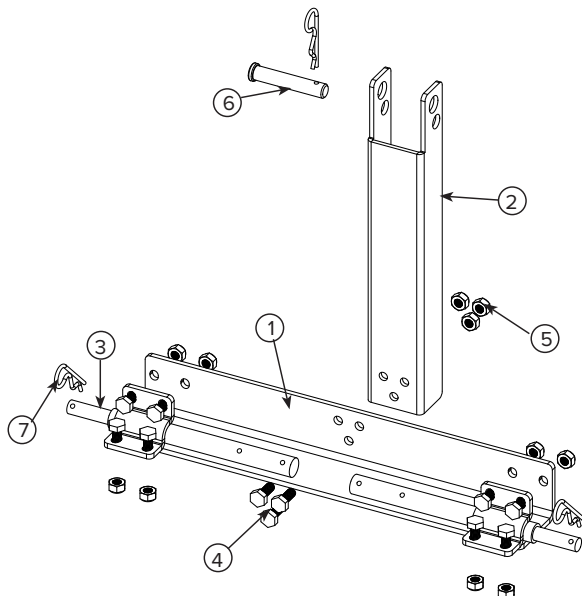

208T Special Hitch COMPONENT LIST

KEY #	PART #	NAME	QTY
1	01-01-1922	208T Draw Bar	1
2	01-01-1923	Strut	1
3	01-02-172	Pin weldment	2
4	01-01-802	M10 x 25mm Hex bolt	12
5	01-01-803	M10 Lock nut	12
6	01-01-1796	5/8" Hitch pin - Category 0	1
7	01-01-880	Bridge pin, large	6

3-Point John Deere iMatch Installation

1. Attach the Strut (2) to the Draw Bar (1) as shown in Figure 1. Secure with three M10 bolts (4) and lock nuts (5). Tighten firmly.
2. Connect the pin weldments to the Draw Bar. Connect the pin weldments (3) with the long end facing out as shown in Figure 2. Secure each pin weldment to the Draw Bar using four M10 bolts and lock nuts per side.
3. Place one provided bridge pin through each of the inner holes in the pin weldment. Slide one lower bushing onto each pin weldment, and secure by placing a second bridge pin through the outer set of holes on the pin weldment. (Fig. 2)
4. Connect your 3-point hitch adapter to your JD iMatch by placing the two lower bushings into the lower hooks on the Quick Hitch (Fig. 3). Lock in place.
5. Place the upper bushing in the upper hook of your JD iMatch, then attach strut using the $\frac{3}{4}$ " category 1 hitch pin through the strut's upper hole and secure with a large bridge pin (Fig. 4).
6. If your mower deck is coupled to your 3-point hitch, please set the mower height to where you would like for mowing, and then set the 3-point hitch so the Draw Bar is 12 inches off the ground. Next, adjust the top arm of your 3-point hitch so that the Strut is in a vertical position (Fig. 5).

That's it. Your 3-point Special Hitch installation is complete.

Note: Check the bolts before each use to make sure everything is tight. An extra M10 bolt, M10 lock nut and bridge fastener are included in case you need them.

Tip: A small amount of grease on the Cyclone Rake hitch pins will help minimize Draw Bar wear over time.

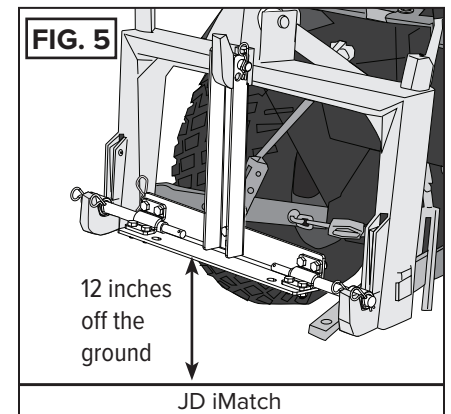
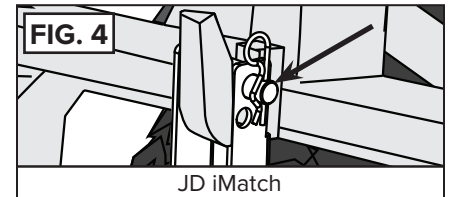
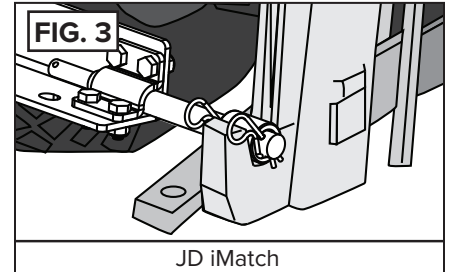
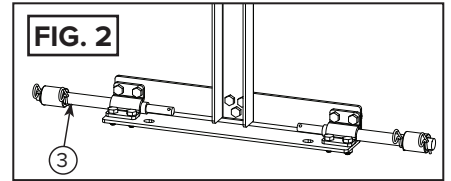
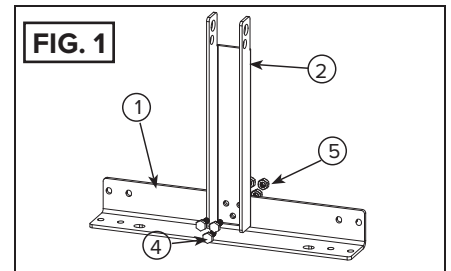

WARNING

Do not attempt to lift your Cyclone Rake off the ground using your 3-point Special Hitch. Damage to the Cyclone Rake and to your hitch will result. This equipment is not designed to be lifted. Damage from lifting is not covered by your warranty.

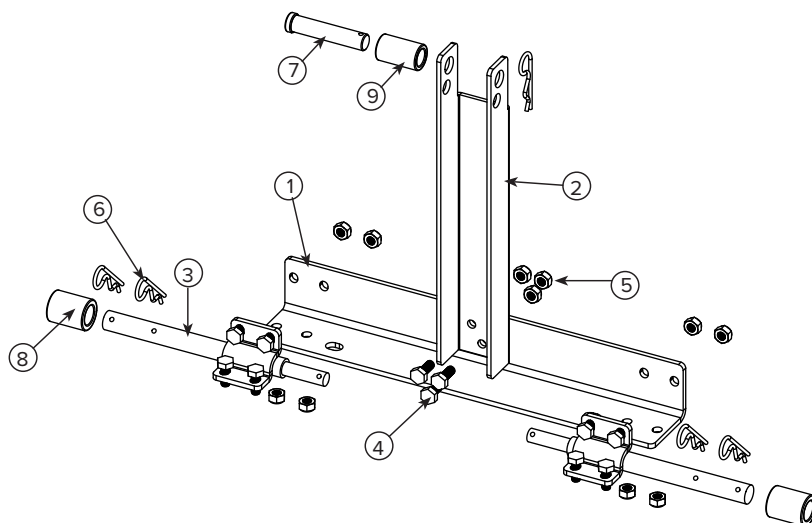

208T JD iMatch Special Hitch COMPONENT LIST

KEY #	PART #	NAME	QTY
1	01-01-1922	208T Draw Bar	1
2	01-01-1923	Strut	1
3	01-02-172	Pin weldment	2
4	01-01-802	M10 x 25mm Hex bolt	12
5	01-01-803	M10 Lock nut	12
6	01-01-880	Bridge pin, large	5
7	01-01-849	$\frac{3}{4}$ " Hitch pin - Category 1	1
8	01-01-1920	Lower Bushing	2
9	01-01-1919	Upper Bushing	1